

Accessoires Inox



BFC

QUALITY AT YOUR SERVICE

Cache platine - ronde

Ref ^a	∅	A	∅ B	Matériel	Finition	Prix un.	
100.00130304S.15	26	25	105	AISI 304	Satiné		6
100.00131304S.15	34	14	85	AISI 304	Satiné		6
100.000062523.15	43	14	85	AISI 304	Satiné		6
100.00126304S.15	43	25	105	AISI 304	Satiné		6
100.00101304S.15	43	16	105	AISI 304	Satiné		6
100.00127304S.15	49	25	105	AISI 304	Satiné		8
100.00132304S.15	49	16	105	AISI 304	Satiné		6

100.00131316S.15	34	14	85	AISI 316	Satiné		6
100.062523316.15	43	14	85	AISI 316	Satiné		6
100.00126316S.15	43	25	105	AISI 316	Satiné		8
100.00127316S.15	49	25	105	AISI 316	Satiné		8

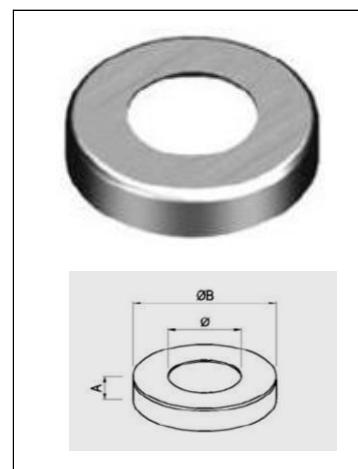

Cache platine - ronde

Ref ^a	∅	A	∅ B	Matériel	Finition	Prix un.	
100.062525316.15	43	25	105	AISI 316	Satiné		6

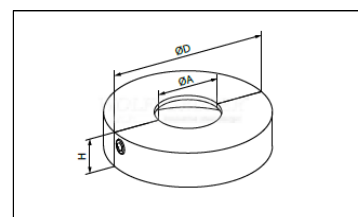

Platine + cache platine fileté

Ref ^a	∅	A	∅ B	Matériel	Finition	Prix un.	
108.82542316S.02	42,4	25	82	AISI 316	Satiné		1
108.82542316P.02	42,4	25	82	AISI 316	Poli		1
108.82543316S.02	43	25	82	AISI 316	Satiné		1
108.82543316P.02	43	25	82	AISI 316	Poli		1



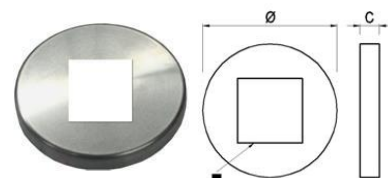

Cache platine ronde p/ tube carre

Ref ^a	□	∅	C	Matériel	Finition	Prix un.	
101.83011304S.02	30	80	11,4	AISI 304	Satiné		6
101.83511304S.02	35	80	11,4	AISI 304	Satiné		6
101.84011304S.02	40	80	11,4	AISI 304	Satiné		6
101.85011304S.02	50	80	11,4	AISI 304	Satiné		6



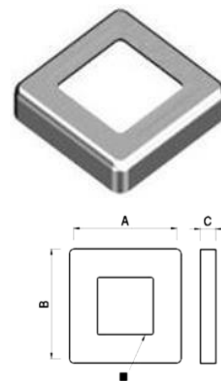

Cache platine carrée p/ tube carré

Ref ^a		A - B	C	Matériel	Finition	Prix un.	
103.63063304S.02	-	63	11,4	AISI 304	Satiné		6
103.62011304S.02	20	63	11,4	AISI 304	Satiné		6
103.62511304S.02	25	63	11,4	AISI 304	Satiné		6
103.63011304S.02	30	63	11,4	AISI 304	Satiné		6
103.77011304S.02	-	77	11,4	AISI 304	Satiné		6
103.77011304S.09	30	77	11,4	AISI 304	Satiné		6
103.77511304S.09	35	77	11,4	AISI 304	Satiné		6
103.77111304S.02	40	77	11,4	AISI 304	Satiné		6
103.77211304S.09	50	77	11,4	AISI 304	Satiné		6
103.10824316S.15	40	108	24	AISI 316	Satiné		6



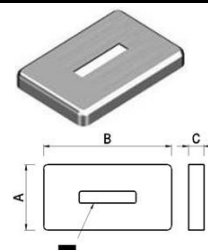

Cache platine rectangulaire p/ barre

Ref ^a		A	B	C	Matériel	Finition	Prix un.	
104.84061304S.09	40X6	80	56	10	AISI 304	Satiné		6
104.84008304S.09	40X8	80	56	10	AISI 304	Satiné		6
104.84010304S.09	40X10	80	56	10	AISI 304	Satiné		6
104.84020304S.09	40X20	80	56	10	AISI 304	Satiné		6



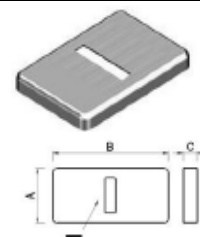

Cache platine rectangulaire p/ barre

Ref ^a		A	B	C	Matériel	Finition	Prix un.	
104.94008304S.09	40X6	80	56	10	AISI 304	Satiné		6
104.94010304S.09	40X8	80	56	10	AISI 304	Satiné		6
104.94020304S.09	40X10	80	56	10	AISI 304	Satiné		6
104.94061304S.09	40X20	80	56	10	AISI 304	Satiné		10



Cache platine ronde p/ barre

Ref ^a		∅	C	Matériel	Finition	Prix un.	
102.84006304S.02	40X6	80	11,4	AISI 304	Satiné		6
102.84008304S.02	40X8	80	11,4	AISI 304	Satiné		6
102.84010304S.02	40X10	80	11,4	AISI 304	Satiné		6
102.85008304S.02	50X8	80	11,4	AISI 304	Satiné		6
102.85010304S.02	50X10	80	11,4	AISI 304	Satiné		12

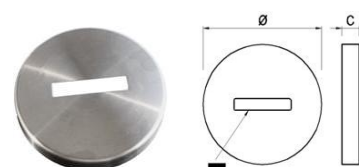

Bouchon / Embout plat

Ref ^a	Ø	Matériel	Finition	Prix un.	
121.01215304S.02	12 X 1,5	AISI 304	Satiné		20
121.01615304S.02	16 X 1,5	AISI 304	Satiné		20
121.01815304S.02	18 X 1,5	AISI 304	Satiné		20
121.02015304S.02	20 X 1,5	AISI 304	Satiné		20
121.02515304S.02	25 X 1,5	AISI 304	Satiné		20
121.04215304S.02	42,4 X 1,5	AISI 304	Satiné		20
121.04815304S.02	48,3 X 1,5	AISI 304	Satiné		20
121.05015304S.02	50,8 X 1,5	AISI 304	Satiné		20
121.01220304S.02	12 X 2,0	AISI 304	Satiné		20
121.01620304S.02	16 X 2,0	AISI 304	Satiné		20
121.01820304S.02	18 X 2,0	AISI 304	Satiné		20
121.02020304S.02	20 X 2,0	AISI 304	Satiné		20
121.02520304S.02	25 X 2,0	AISI 304	Satiné		20
121.04220304S.15	42,4 X 2,0	AISI 304	Satiné		20
121.04820304S.15	48,3 X 2,0	AISI 304	Satiné		20
121.05020304S.02	50,8 X 2,0	AISI 304	Satiné		20
121.06020304S.15	60,3 X 2,0	AISI 304	Satiné		20

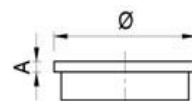

Bouchon / Embout plat taraude 8mm

Ref ^a	Ø	Matériel	Finition	Prix un.	
123.22620304S.15	26,9 X 2,0	AISI 304	Satiné		20
123.23320304S.15	33,7 X 2	AISI 304	Satiné		20
123.24220304S.15	42,4 X 2,0	AISI 304	Satiné		10
123.24820304S.15	48 X 2,0	AISI 304	Satiné		10
123.26020304S.15	60,3 X 2,0	AISI 304	Satiné		10

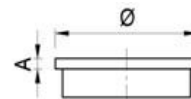

Bouchon / Embout arrondi

Ref ^a	Ø	A	H	Matériel	Finition	Prix un.	
122.04220304S.15	42,4 X 2,0	6	9	AISI 304	Satiné		20
122.04226304S.15	42,4 X 2,6	6	10	AISI 304	Satiné		20
122.04820304S.15	48,3 X 2,0	7,5	12	AISI 304	Satiné		20
122.04826304S.15	48,3 X 2,6	7,5	11	AISI 304	Satiné		20
122.04220316S.15	42,4 X 2,0	6	10	AISI 316	Satiné		20
122.04820316S.15	48,3 X 2,0	7,5	10	AISI 316	Satiné		20
122.04220316P.15	42,4 X 2,0	6	12	AISI 316	Poli		20
122.04820316P.15	48,3 X 2,0	7,5	12	AISI 316	Poli		20



Bouchon / Embout arrondi

Ref ^a	Ø	A	H	Matériel	Finition	Prix un.	
122.11215304S.15	12 X 1,5	3	6	AISI 304	Satiné		20
122.11415304S.15	14 X 1,5	3	6	AISI 304	Satiné		20
122.13020304S.15	30 X 2,0	5	6	AISI 304	Satiné		20
122.13320304S.15	33,7 X 2,0	6	6	AISI 304	Satiné		20
122.14020304S.15	40 X 2,0	6,5	6	AISI 304	Satiné		20
122.14220304S.15	42,4 X 2,0	7	6	AISI 304	Satiné		20
122.14820304S.15	48,3 X 2,0	8	6	AISI 304	Satiné		20



Bouchon / Embout arrondi taraude 8mm

Ref ^a	∅	A	H	Matériel	Finition	Prix un.	
123.02620304S.15	26 X 2,0	3	10	AISI 304	Satiné		20
123.03320304S.15	33,7 X 2,0	5	12	AISI 304	Satiné		20
123.03326304S.15	33,7 X 2,6	5	12	AISI 304	Satiné		20
123.04220304S.15	42,4 X 2,0	6	12	AISI 304	Satiné		20
123.04226304S.15	44,2 X 2,6	6,0	12	AISI 304	Satiné		20
123.04820304S.15	48,3 X 2,0	7,5	12	AISI 304	Satiné		20
123.04826304S.15	48,3 X 2,6	7,5	12	AISI 304	Satiné		20

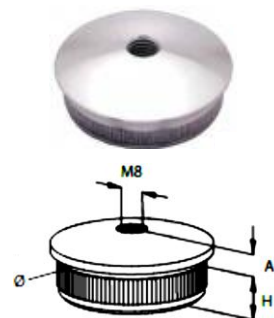

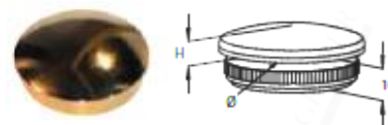

Bouchon / Embout arrondi poli jaune

Ref ^a	∅	H	Matériel	Finition	Prix un.	
122.33320304P.15	33,7 X 2,0	5	AISI 304	Satiné		20
122.34220304P.15	42,4 X 2,0	7,5	AISI 304	Satiné		20





Bouchon / Embout carree arrondi

Ref ^a		Matériel	Finition	Prix un.	
127.404030401.09	40 X 40 X 1,5	AISI 304	Satiné		20
127.404030406.09	40 X 40 X 2,0	AISI 304	Satiné		20



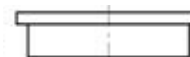

Bouchon / Embout carree plat

Ref ^a		Matériel	Finition	Prix un.	
126.404030404.04	40 X 40 X 1,5	AISI 304	Satiné		20
126.404030401.04	40 X 40 X 2,0	AISI 304	Satiné		20



Bouchon / Embout carree plat taraude 8mm

Ref ^a		Matériel	Finition	Prix un.	
126.404030405.04	40 X 40 X 1,5	AISI 304	Satiné		20
126.404030403.04	40 X 40 X 2,0	AISI 304	Satiné		20



Bouchon / Embout carree arrondi taraude 8mm

Ref ^a	□	Matériel	Finition	Prix un.	
127.404030407.09	40 X 40 X 1,5	AISI 304	Satiné		20
127.404030402.09	40 X 40 X 2,0	AISI 304	Satiné		20



Tige taraude Filetee 8mm

Ref ^a	∅	L	Matériel	Finition	Prix un.	
128.01265304S.15	12	65	AISI 304	Satiné		20
128.12125304S.15	12	125	AISI 304	Satiné		20
128.01465304S.15	14	65	AISI 304	Satiné		20
128.14125304S.15	14	125	AISI 304	Satiné		20

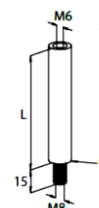

Tige taraude Filetee orientable 8mm

Ref ^a	∅	L	H	Matériel	Finition	Prix un.	
129.14057304S.15	14	57,5	17,5	AISI 304	Satiné		10

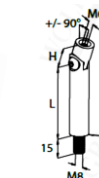

Tige taraude Filetee 8mm

Ref ^a	∅	L	Matériel	Finition	Prix un.	
130.14100304S.15	12	65	AISI 304	Satiné		10

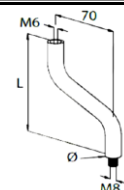

Embout 1/2 sphere a frapper

Ref ^a	∅	A	H	Matériel	Finition	Prix un.	
122.42620304S.15	26,9 X 2,00	14	9	AISI 304	Satiné		20
122.43320304S.15	33,7 X 2,00	17	10	AISI 304	Satiné		20
122.43326304S.15	33,7 X 2,60	17	10	AISI 304	Satiné		20
122.44220304S.15	42,4 X 2,00	21	10	AISI 304	Satiné		20
122.44226304S.15	42,4 X 2,60	21	10	AISI 304	Satiné		20
122.44820304S.15	48,3 X 2,00	24	10	AISI 304	Satiné		20
122.44826304S.15	48,3 X 2,00	24	10	AISI 304	Satiné		20

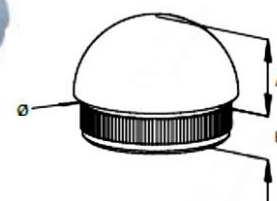

Bouchon carree a souder

Ref ^a	□	A	Matériel	Finition	Prix un.	
126.202030402.09	20 X 20	3,0	AISI 304	-		20
126.252530402.09	25 X 25	3,0	AISI 304	-		20
126.303030402.09	30 X 30	3,0	AISI 304	-		20
126.404030402.09	40 X 40	3,0	AISI 304	-		20
126.505030402.09	50 X 50	3,0	AISI 304	-		20



Bouchon carré a souder, avec un trou

Ref ^a	□	A	∅	Matériel	Finition	Prix un.	
126.202030403.09	20 X 20	3,0	12	AISI 304	-		20
126.252530403.09	25 X 25	3,0	12	AISI 304	-		20
126.303030403.09	30 X 30	3,0	12	AISI 304	-		20
126.404030403.09	40 X 40	3,0	12	AISI 304	-		20
126.505030403.09	50 X 50	3,0	12	AISI 304	-		20

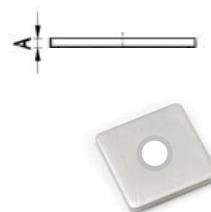

Bouchon ronde a souder

Ref ^a	∅	A	Matériel	Finition	Prix un.	
126.002030401.09	20,0	3,0	AISI 304	-		20
126.002530401.09	25,0	3,0	AISI 304	-		20
126.003030401.09	30,0	3,0	AISI 304	-		20
126.004030401.09	40,0	3,0	AISI 304	-		20
126.004230401.09	42,4	3,0	AISI 304	-		20
126.005030401.09	50,8	3,0	AISI 304	-		20



Bouchon ronde a souder, avec un trou

Ref ^a	∅	A	∅	Matériel	Finition	Prix un.	
126.002030402.09	20,0	3,0	12	AISI 304	-		20
126.002530402.09	25,0	3,0	12	AISI 304	-		20
126.003030402.09	30,0	3,0	12	AISI 304	-		20
126.004030402.09	40,0	3,0	12	AISI 304	-		20
126.004230402.09	42,4	3,0	12	AISI 304	-		20
126.005030402.09	50,8	3,0	12	AISI 304	-		20



Bouchon arrondi a souder

Ref ^a	∅	A	Matériel	Finition	Prix un.	
126.002130404.15	21	5	AISI 304	-		20
126.002730404.15	27	5	AISI 304	-		20
126.003330404.15	33	6	AISI 304	-		20
126.004230404.15	42	7	AISI 304	-		20
126.004830404.15	48	8	AISI 304	-		20
126.005230404.15	52	8	AISI 304	-		20
126.006030404.15	60	9	AISI 304	-		20

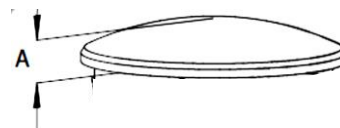

Coude 90° petit rayon

Ref ^a	∅	H	Matériel	Finition	Prix un.	
141.01000304S.15	33,7 x 2	35	AISI 304	Satiné		10
141.02000304S.15	42,4 x 2	43	AISI 304	Satiné		10
141.03000304S.15	48,3 x 2	50	AISI 304	Satiné		10
141.02000316S.15	42,4 x 2	43	AISI 316	Satiné		10
141.02000316S.15	48,3 x 2	50	AISI 316	Satiné		10
141.02000316P.15	42,4 x 2	43	AISI 316	Poli		10
141.02000316P.15	48,3 x 2	50	AISI 316	Poli		10

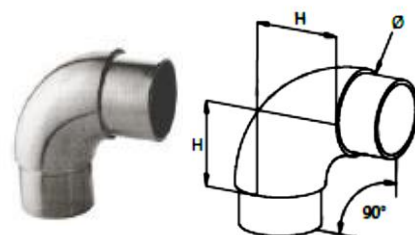

Coude 90° petit rayon à souder

Ref ^a	Ø	H	Matériel	Finition	Prix un.	
140.02000304B.15	26,9 X 2,00	30	AISI 304	-		20
140.03000304B.15	30 X 2,00	44	AISI 304	-		20
140.03300304B.15	33,7 X 2,00	38	AISI 304	-		20
140.04000304B.15	40 X 2,00	61	AISI 304	-		20
140.04200304B.15	42,4 X 2,00	48	AISI 304	-		20
140.04800304B.15	48,3 X 2,00	57	AISI 304	-		20
140.06000304B.15	60,3 X 2,00	76	AISI 304	-		20
140.02000304S.15	26,9 X 2,00	30	AISI 304	Satiné		20
140.03000304S.15	30 X 2,00	44	AISI 304	Satiné		20
140.03300304S.15	33,7 X 2,00	38	AISI 304	Satiné		20
140.04000304S.15	40 X 2,00	61	AISI 304	Satiné		20
140.04200304S.15	42,4 X 2,00	48	AISI 304	Satiné		20
140.04800304S.15	48,3 X 2,00	57	AISI 304	Satiné		20
140.06000304S.15	60,3 X 2,00	76	AISI 304	Satiné		20
140.04200316S.15	42,4 X 2,00	48	AISI 316	Satiné		20
140.04800316S.15	48,3 X 2,00	57	AISI 316	Satiné		20

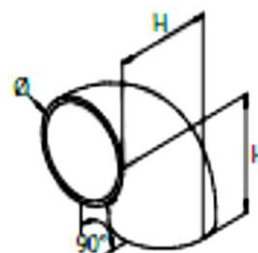

Coude 90° angle vif

Ref ^a	Ø	H	Matériel	Finition	Prix un.	
142.04000304S.15	33,7 X 2,00	30	AISI 304	Satiné		10
142.01000304S.15	42,4 X 2,00	44	AISI 304	Satiné		10
142.03000304S.15	48,3 X 2,00	38	AISI 304	Satiné		10
142.01000316S.15	42,4 X 2,00	61	AISI 316	Satiné		10
142.03000316S.15	48,3 X 2,00	48	AISI 316	Satiné		10
142.01000316P.15	42,4 X 2,00	57	AISI 316	Poli		10
142.03000316P.15	48,3 X 2,00	76	AISI 316	Poli		10

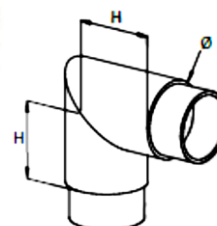

Coude inox pivotant

Ref ^a	Ø	A	Matériel	Finition	Prix un.	
142.01000304S.08	42,4 x 2	64,4	AISI 304	Satiné		10
142.02000304S.08	50,8 x 2	64,4	AISI 304	Satiné		10

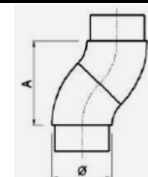

Platine avec coude 90° petit rayon

Ref ^a	Ø	A	Ø B	Matériel	Finition	Prix un.	
144.01000304S.02	42,4 x 2	72,4	77	AISI 304	Satiné		2
144.02000304S.02	42,4 x 1,5	72,4	77	AISI 304	Satiné		2
144.01000316S.02	42,4 x 2	103	85	AISI 316	Satiné		2
144.02000316S.02	50,8 X 1,5	-	-	AISI 316	Satiné		2

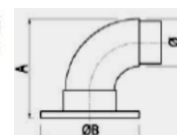

Crosse boucle

Ref ^a	Ø	Matériel	Finition	Prix un.	
131.54220304S.15	42,4 x 2	AISI 304	Satiné		10





Crosse

Ref ^a	∅	Matériel	Finition	Prix un.	
131.64220304S.15	42,4 x 2	AISI 304	Satiné		10



Platine carree

Ref ^a		Matériel	Finition	Prix un.	
106.101006304.15	100x100x6	AISI 304	Satiné		5
106.110010304.15	100x100x10	AISI 304	Satiné		5

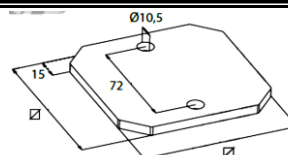

Platine carree

Ref ^a	D	∅ A	Matériel	Finition	Prix un.	
106.808006304.15	80x80x6	9	AISI 304	Satiné		5
106.010106304.15	100x100x6	11	AISI 304	Satiné		5
106.010010304.15	100x100x10	14	AISI 304	Satiné		10
106.121206304.15	120x120x6	11	AISI 304	Satiné		5

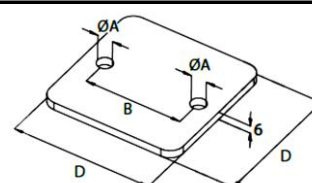

Platine carree

Ref ^a		Matériel	Finition	Prix un.	
106.021006304.15	100x100x6	AISI 304	Satiné		5

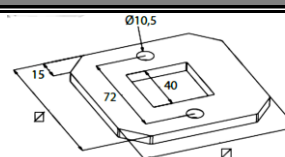

Platine rond

Ref ^a	∅	H	Matériel	Finition	Prix un.	
105.010353040.15	35	4	AISI 304	Satiné		10
105.010403040.15	40	4	AISI 304	Satiné		10
105.010423040.15	42	4	AISI 304	Satiné		10
105.010453040.15	45	4	AISI 304	Satiné		10
105.010483040.15	48	4	AISI 304	Satiné		10
105.010503040.15	50	4	AISI 304	Satiné		10
105.010523040.15	52	4	AISI 304	Satiné		10
105.010603040.15	60	4	AISI 304	Satiné		10
105.010703040.15	70	4	AISI 304	Satiné		10
105.010803040.15	70	6	AISI 304	Satiné		5
105.020703040.15	80	4	AISI 304	Satiné		5
105.020803040.15	80	6	AISI 304	Satiné		5
105.021003040.15	100	6	AISI 304	Satiné		5
105.021203040.15	120	6	AISI 304	Satiné		5
105.021403040.15	140	6	AISI 304	Satiné		5
105.100103040.00	100	10	AISI 304	Satiné		5



Platine rond

Ref ^a	∅ D	A	S	∅ B	Matériel	Finition	Prix un.	
105.062532304.15	80	56	6	9	AISI 304	Satiné		5
105.062534304.15	100	72	6	10,5	AISI 304	Satiné		5
105.062536304.15	100	72	8	10,5	AISI 304	Satiné		5
105.062537304.15	120	85	8	10,5	AISI 304	Satiné		5

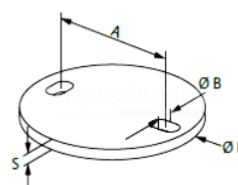

Platine rond

Ref ^a	∅ D	A	C	∅ B	Matériel	Finition	Prix un.	
105.062540304.15	80	56	34	9	AISI 304	Satiné		5
105.062541304.15	80	61,5	43	10,5	AISI 304	Satiné		5
105.062544304.15	100	72	43	10,5	AISI 304	Satiné		5
105.062545304.15	100	74,5	49	10,5	AISI 304	Satiné		5

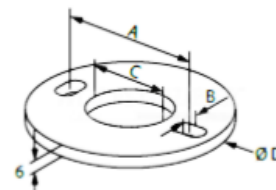

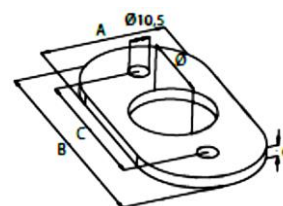

Platine arrondi

Ref ^a	A	B	C	∅	Matériel	Finition	Prix un.	
107.065032304.15	55	125	75	34	AISI 304	Satiné		1
107.065036304.15	65	125	80	43	AISI 304	Satiné		1
107.065038304.15	65	115	80	49	AISI 304	Satiné		1



Platine fixation a l'angle

Ref ^a	∅	t	Matériel	Finition	Prix un.	
139.000262581.15	33,7	40	AISI 304	Satiné		10
139.000262585.15	42,4	40	AISI 304	Satiné		10
139.000262587.15	48,3	40	AISI 304	Satiné		10
139.000262579.15		40	AISI 304	Satiné		10

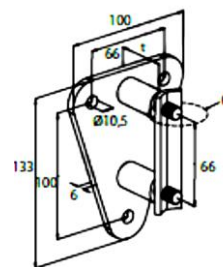

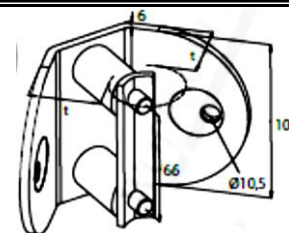

Platine fixation d'angle a l'angle

Ref ^a	∅	t	Matériel	Finition	Prix un.	
139.000362569.15	33,7	40	AISI 304	Satiné		10
139.000362570.15	42,4	40	AISI 304	Satiné		10
139.000362571.15	48,3	40	AISI 304	Satiné		10



Platine fixation a l'angle

Ref ^a	∅	t	Matériel	Finition	Prix un.	
139.000562582.15	33,7	40	AISI 304	Satiné		10
139.000562586.15	42,4	40	AISI 304	Satiné		10
139.000562588.15	48,3	40	AISI 304	Satiné		10
139.000562589.15		40	AISI 304	Satiné		10

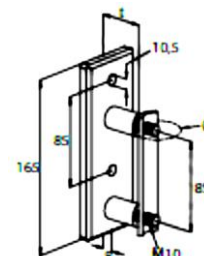

Platine fixation a l'angle

Ref ^a	t	Matériel	Finition	Prix un.	
139.000462580.15	40	AISI 304	Satiné		10

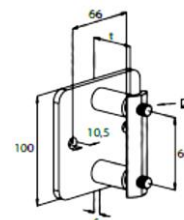

Platine fixation a l'anglaise

Ref ^a	Ø	t	Matériel	Finition	Prix un.	
139.000662563.15	33,7	40	AISI 304	Satiné		10
139.000662564.15	42,4	40	AISI 304	Satiné		10
139.000662565.15	48,3	40	AISI 304	Satiné		10

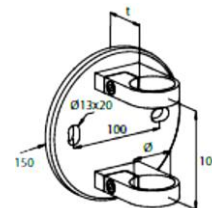

Platine fixation a l'anglaise

Ref ^a	Ø	t	Matériel	Finition	Prix un.	
139.000762517.15	33,7	40	AISI 304	Satiné		10
139.000762518.15	42,4	40	AISI 304	Satiné		10
139.000762519.15	48,3	40	AISI 304	Satiné		10

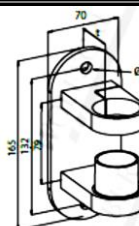

Platine fixation a l'anglaise

Ref ^a	Ø	t	Matériel	Finition	Prix un.	
139.000862572.15	33,7	40	AISI 304	Satiné		10
139.000862576.15	42,4	40	AISI 304	Satiné		10
139.000862578.15	48,3	40	AISI 304	Satiné		10

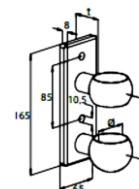

Fixation poteau

Ref ^a	Ø	t	Matériel	Finition	Prix un.	
139.000962591.15	33,7	40	AISI 304	Satiné		10
139.000962592.15	42,4	40	AISI 304	Satiné		10
139.000962593.15	48,3	40	AISI 304	Satiné		10

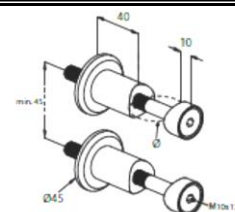

Fixation poteau

Ref ^a	Ø	t	Matériel	Finition	Prix un.	
139.001062596.15	33,7	40	AISI 304	Satiné		10
139.001062597.15	42,4	40	AISI 304	Satiné		10
139.001062598.15	48,3	40	AISI 304	Satiné		10

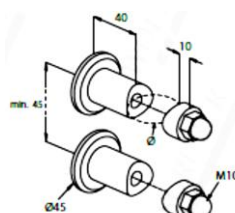

Platine poteau ronde

Ref ^a	Ø	t	Matériel	Finition	Prix un.	
139.001162573.15	42,4	40	AISI 304	Satiné		10

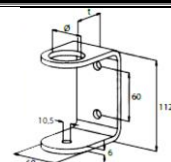

Platine poteau ronde

Ref ^a	Ø	t	Matériel	Finition	Prix un.	
139.001262574.15	42,4	40	AISI 304	Satiné		10

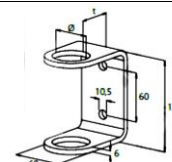

Support tube

Ref ^a	Ø	A	L	Matériel	Finition	Prix un.	
120.63400C304.15	33,7	10	20	AISI 304	Satiné		20
120.63406C304.15	42,4	10	20	AISI 304	Satiné		20
120.63408C304.15	48,3	10	20	AISI 304	Satiné		20
120.63412C304.15	33,7	12	20	AISI 304	Satiné		20
120.63416C304.15	42,4	12	20	AISI 304	Satiné		20
120.63418C304.15	48,3	12	20	AISI 304	Satiné		20
120.63422C304.15	33,7	14	20	AISI 304	Satiné		20
120.63426C304.15	42,4	14	20	AISI 304	Satiné		20
120.63428C304.15	48,3	14	20	AISI 304	Satiné		20
120.63432C304.15	33,7	16	24	AISI 304	Satiné		20
120.63436C304.15	42,4	16	24	AISI 304	Satiné		20
120.63438C304.15	48,3	16	24	AISI 304	Satiné		20

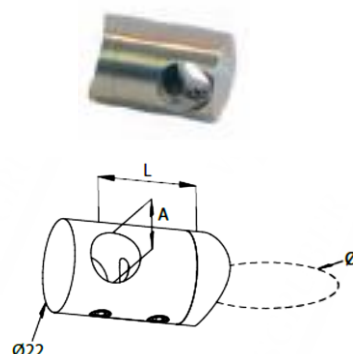

Support barre

Ref ^a	<input type="checkbox"/>	A	L	Matériel	Finition	Prix un.	
119.63409C304.15	<input type="checkbox"/>	10	20	AISI 304	Satiné		20
119.63419C304.15	<input type="checkbox"/>	12	20	AISI 304	Satiné		20
119.63429C304.15	<input type="checkbox"/>	14	20	AISI 304	Satiné		20
119.63439C304.15	<input type="checkbox"/>	16	24	AISI 304	Satiné	5,39 €	20



Support barre

Ref ^a	<input type="checkbox"/>	Matériel	Finition	Prix un.	
119.635733040.15	<input type="checkbox"/>	AISI 304	Satiné		20

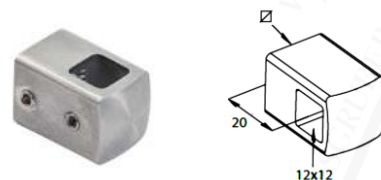

Support barre

Ref ^a	<input type="checkbox"/>	Ø	Matériel	Finition	Prix un.	
119.635703040.15	<input type="checkbox"/>	20	AISI 304	Satiné		20
119.635723040.15	<input type="checkbox"/>	12	AISI 304	Satiné		20

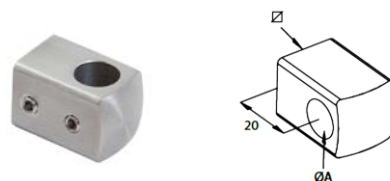

Ref ^a	Ø	A	L	Matériel	Finition	Prix un.	
120.631133040.15	33,7	12	55	AISI 304	Satiné		20
120.631143040.15	42,4	12	55	AISI 304	Satiné		20
120.631153040.15	48,3	12	55	AISI 304	Satiné		20
120.631123040.15	33,7	14	55	AISI 304	Satiné		20
120.631163040.15	42,4	14	55	AISI 304	Satiné		20
120.631163040.15	48,3	14	55	AISI 304	Satiné		20
119.631103040.15	<input type="checkbox"/>	12	59	AISI 304	Satiné		20
119.631193040.15	<input type="checkbox"/>	14	59	AISI 304	Satiné		20

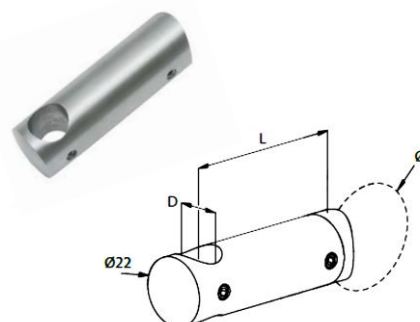

Pince a verre orientable - INOX

Ref ^a	<input type="checkbox"/>	Verre	Matériel	Finition	Prix un.	
124.80104304S.01	<input type="checkbox"/>	8 - 10mm	AISI 304	Satiné	7,04 €	12
124.80104304P.01	<input type="checkbox"/>	8 - 10mm	AISI 304	Poli	8,74 €	12
124.80104316S.01	<input type="checkbox"/>	8 - 10mm	AISI 316	Satiné	8,75 €	12

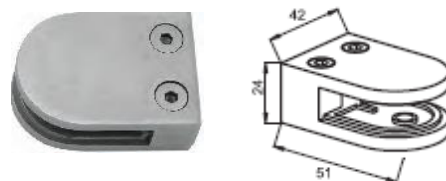

Pince a verre orientable - INOX

Ref ^a	∅	Verre	Matériel	Finition	Prix un.	
124.80103304S.01	42,4	8 - 10mm	AISI 304	Satiné		12
124.80103304P.01	42,4	8 - 10mm	AISI 304	Poli		12
124.80103316S.01	42,4	8 - 10mm	AISI 316	Satiné		12

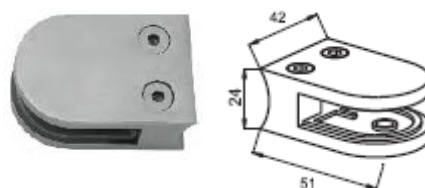

Pince a verre orientable - INOX

Ref ^a	<input type="checkbox"/>	Verre	Matériel	Finition	Prix un.	
124.80204304S.01	<input type="checkbox"/>	8 - 10mm	AISI 304	Satiné		12
124.80204304P.01	<input type="checkbox"/>	8 - 10mm	AISI 304	Poli		12
124.80204316S.01	<input type="checkbox"/>	8 - 10mm	AISI 316	Satiné		12

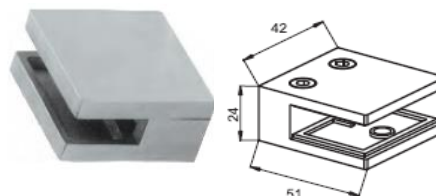

Pince a verre orientable - INOX

Ref ^a	∅	Verre	Matériel	Finition	Prix un.	
124.80203304S.01	42,4	8 - 10mm	AISI 304	Satiné		12
124.80203304P.01	42,4	8 - 10mm	AISI 304	Poli		12
124.80203316S.01	42,4	8 - 10mm	AISI 316	Satiné		12

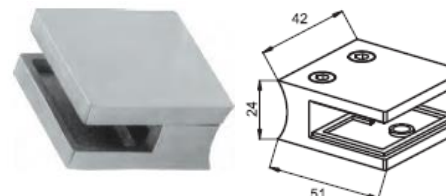

Pince a verre - ZAMAC

Ref ^a	<input type="checkbox"/>	Verre	Matériel	Finition	Prix un.	
124.3000600Z1.15	<input type="checkbox"/>	6mm	Zamac	Zamac		12
124.3000800Z1.15	<input type="checkbox"/>	8mm	Zamac	Zamac		12
124.3001000Z1.15	<input type="checkbox"/>	10mm	Zamac	Zamac		12

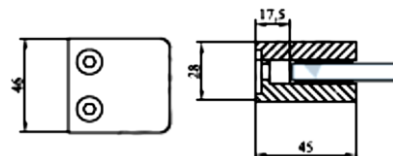

Pince a verre - ZAMAC, FINITION INOX

Ref ^a	<input type="checkbox"/>	Verre	Matériel	Finition	Prix un.	
124.3000620Z2.15	<input type="checkbox"/>	6mm	Zamac	Inox		12
124.3000820Z2.15	<input type="checkbox"/>	8mm	Zamac	Inox		12
124.3001020Z2.15	<input type="checkbox"/>	10mm	Zamac	Inox		12

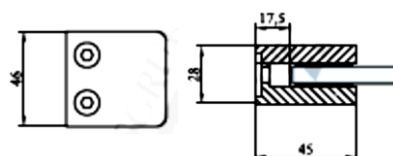

Pince a verre - ZAMAC

Ref ^a	∅	Verre	Matériel	Finition	Prix un.	
124.3420600Z1.15	42,4	6mm	Zamac	Zamac		12
124.3420800Z1.15	42,4	8mm	Zamac	Zamac		12
124.3421000Z1.15	42,4	10mm	Zamac	Zamac		12

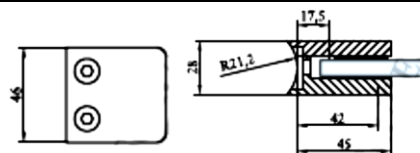

Pince a verre - ZAMAC, FINITION INOX

Ref ^a	∅	Verre	Matériel	Finition	Prix un.	
124.3420620Z2.15	42,4	6mm	Zamac	Inox		12
124.3420820Z2.15	42,4	8mm	Zamac	Inox		12
124.3421020Z2.15	42,4	10mm	Zamac	Inox		12

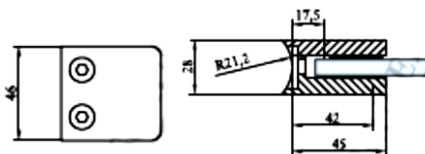

Pince a verre - ZAMAC

Ref ^a	<input type="checkbox"/>	Verre	Matériel	Finition	Prix un.	
124.7000600Z1.15	<input type="checkbox"/>	6mm	Zamac	Zamac		12
124.7000800Z1.15	<input type="checkbox"/>	8mm	Zamac	Zamac		12
124.7001000Z1.15	<input type="checkbox"/>	10mm	Zamac	Zamac		12

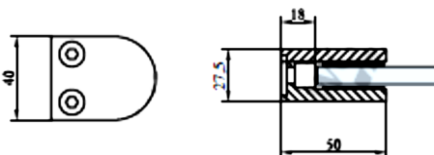

Pince a verre - ZAMAC, FINITION INOX

Ref ^a	<input type="checkbox"/>	Verre	Matériel	Finition	Prix un.	
124.7000620Z2.15	<input type="checkbox"/>	6mm	Zamac	Inox		12
124.7000820Z2.15	<input type="checkbox"/>	8mm	Zamac	Inox		12
124.7001020Z2.15	<input type="checkbox"/>	10mm	Zamac	Inox		12

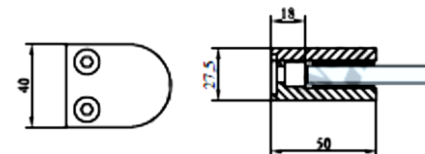

Pince a verre - ZAMAC

Ref ^a	∅	Verre	Matériel	Finition	Prix un.	
124.7420600Z1.15	42,4	8 - 10mm	Zamac	Zamac		12
124.7420800Z1.15	42,4	8 - 10mm	Zamac	Zamac		12
124.7421000Z1.15	42,4	8 - 10mm	Zamac	Zamac		12

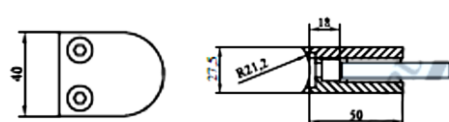

Pince a verre - ZAMAC, FINITION INOX

Ref ^a	∅	Verre	Matériel	Finition	Prix un.	
124.7420620Z2.15	42,4	6mm	Zamac	Inox		12
124.7420820Z2.15	42,4	8mm	Zamac	Inox		12
124.7421020Z2.15	42,4	10mm	Zamac	Inox		12

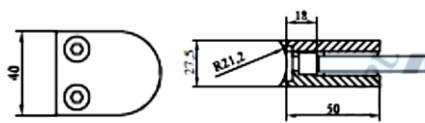

Pince a verre - ZAMAC

Ref ^a	<input type="checkbox"/>	Verre	Matériel	Finition	Prix un.	
124.1001000Z1.15	<input type="checkbox"/>	10mm	Zamac	Zamac		12
124.1001200Z1.15	<input type="checkbox"/>	12mm	Zamac	Zamac		12
124.1001400Z1.15	<input type="checkbox"/>	14mm	Zamac	Zamac		12

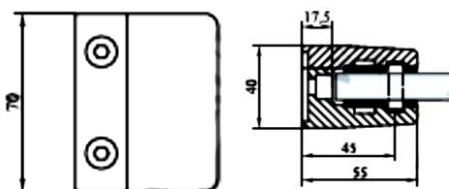

Pince a verre - ZAMAC, FINITION INOX

Ref ^a	<input type="checkbox"/>	Verre	Matériel	Finition	Prix un.	
124.1001020Z2.15	<input type="checkbox"/>	10mm	Zamac	Inox		12
124.1001220Z2.15	<input type="checkbox"/>	12mm	Zamac	Inox		12
124.1001420Z2.15	<input type="checkbox"/>	14mm	Zamac	Inox		12

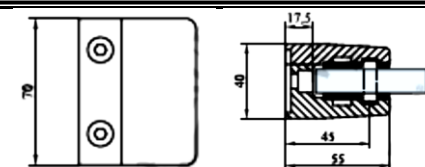

Pince a verre - ZAMAC

Ref ^a	∅	Verre	Matériel	Finition	Prix un.	
124.1481000Z1.15	48,3	10mm	Zamac	Zamac		12
124.1481200Z1.15	48,3	12mm	Zamac	Zamac		12
124.1481400Z1.15	48,3	14mm	Zamac			12

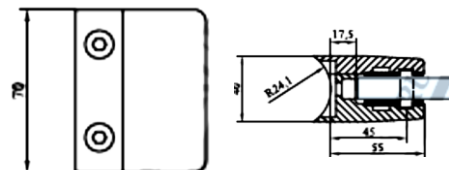

Pince a verre - ZAMAC, FINITION INOX

Ref ^a	∅	Verre	Matériel	Finition	Prix un.	
124.1481020Z2.15	48,3	10mm	Zamac	Inox		12
124.1481220Z2.15	48,3	12mm	Zamac	Inox		12
124.1481420Z2.15	48,3	14mm	Zamac	Inox		12

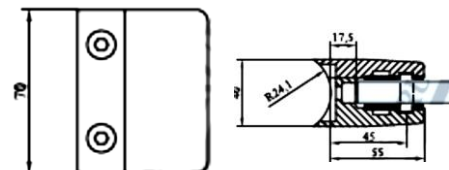

Pince a verre orientable - INOX

Réf.	∅ □	Verre	Matériel	Finition	Prix un.	
124.80010304S.06	∅ 42,2	6-12mm	AISI 304	Satiné		1
124.80011304S.06	□	6-12mm	AISI 304	Satiné		1



Ventouses a verre

Ref ^a	Modèle	∅		Prix un.	
150.001001008.23	Venal - 1	123	40		1
150.001001009.23	Venal - 2	117	50		1
150.001001001.06	Venal - 3	123	85		1
150.001001006.07	Venal - 4	110	-		1
150.001001007.07	Venal - 5	-	80		1

Venal - 1



Venal - 2



Venal - 3



Venal - 4



Venal - 5

